

**Recommended P.C. Board Layout**  
SCALE 8:1

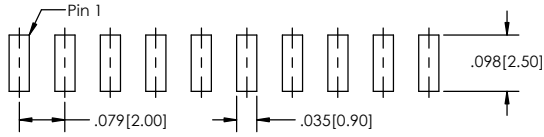

**SINGLE**

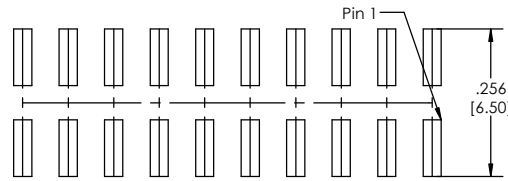

**DOUBLE**

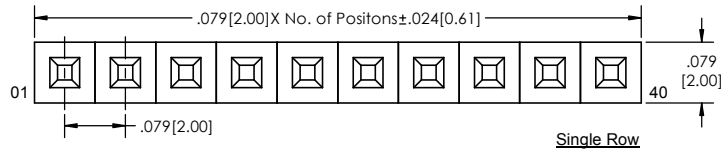
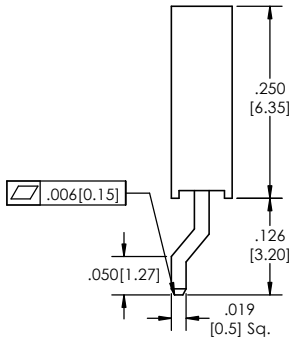
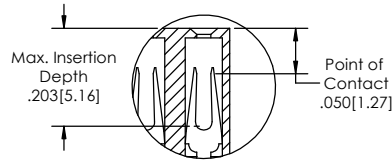

**Single Row**

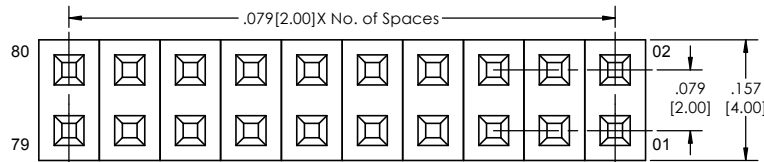
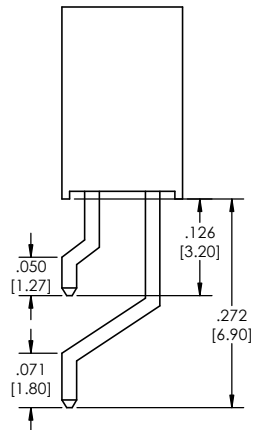

**Double Row**

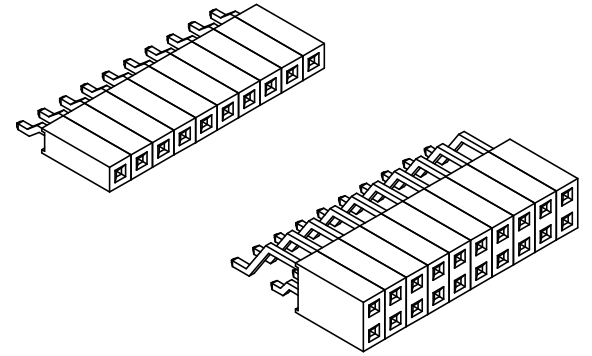

SSHSM-2 [XX] - [X] - [02] - [XX] - [H] - [XXX] - [XX] - [LF]  
(A) (B) (C) (D) (E) (F) (G) (H)

- A. Pins Per Row - 02 through 40
  - B. Row Specification - S= Single Row - D= Double Row
  - C. Pin Option - See Plating Options below
  - D. Plating Options
  - E. Horizontal
  - F. Polarized Position - Leave blank if not needed - If required, specify empty pin position - e.g. 012 for Pin 12
  - G. Packing Information - TR= Tape and Reel - TB= Tube
  - H. Lead Free
- Mates with:
- |         |         |
|---------|---------|
| BSTC    | TSHR    |
| BSTCM   | TSHRE   |
| BSTCR   | TSHS    |
| BSTCRSM | TSHSCM  |
| BSTS    | TTSHC   |
| TBSTC   | TTSHCR  |
| TBSTCM  | TTSHCRE |
| TBSTS   | TTSHR   |
| TSHC    | TTSHRE  |
| TSHCR   | TTSHS   |
| TSHCRM  | TTSHSM  |
- | Plating options |   |
|-----------------|---|
| G               | 10µ Gold on Contact Area/ Flash on Tail       |
| T               | Matte Tin all Over                            |
| GT              | 10µ Gold on Contact Area/ Matte Tin on Tail   |
| H               | 30µ Gold on Contact Area/ Matte Tin on Tail   |
| F               | Gold Flash over Entire Pin                    |
| FT              | Gold Flash on Contact Area/ Matte Tin on Tail |

**Specifications:**  
 Insertion Force- Single Contact only- H Plating:  
 4oz. [1.11N] avg with .079[2.00mm] sq. pin  
 Withdrawal Force- Single Contact only- H Plating:  
 3oz. [0.83N] avg with .079 [2.00mm] sq. pin  
 Current Rating: 2.0 Ampere  
 Insulation Resistance: 1000M Ohms Min.  
 Dielectric Withstanding: 500V AC  
 Contact Resistance: 10M Ohms Max.  
 Operation Temperature: -40°C to +105°C  
 Max. Process Temperature  
 Peak: 260°C up to 10 secs.  
 Process: 230°C up to 60 secs.  
 Wave: 260°C up to 6 secs.  
 Reflow: 260°C up to 10 secs.  
 Manual Solder: 350°C up to 5 secs.

**Materials:**  
 Contact Material: Phosphor Bronze  
 Insulator Material: Nylon 6T  
 Plating: Au or Sn over 50µ" (1.27) Ni

Tails may be clipped to achieve specific dimensions.  
 Products cut to specific sizes are uncancelable/ nonreturnable.  
 Parts are subject to change without notice.



**PROPRIETARY AND CONFIDENTIAL**  
 THE INFORMATION CONTAINED IN THIS DRAWING IS THE SOLE PROPERTY OF Major League Electronics. ANY REPRODUCTION IN PART OR AS A WHOLE WITHOUT THE WRITTEN PERMISSION OF Major League Electronics IS PROHIBITED.

UNLESS OTHERWISE SPECIFIED:		NAME		DATE	
DIMENSIONS ARE IN INCHES		DRAWN	EOW	01/21/15	
TOLERANCES:		CHECKED	GWE	01/21/15	
ONE DECIMALS ±.100		ENG APPR.			
THREE DECIMAL ±.002		MFG APPR.			
FOUR DECIMAL ±.0002		ADDRESS:		TITLE: SSHSM-2-H Series	
INTERPRET GEOMETRIC TOLERANCING PER:		2533 Centennial Blvd.		SIZE DWG. NO.	
MATERIAL:		Jeffersonville, IN 47130		C	
NEXT ASSY USED ON:		Phone: 812-670-4174		REV B	
APPLICATION		Fax: 812-670-4175		SCALE 8:1	
DO NOT SCALE DRAWING		E-Mail: mle@mlelectronics.com		SHEET 1 OF 1	